

Concrete by SADLERSTONE

With an unwavering passion and commitment to concrete, Sadlerstone is at the forefront of the transition of concrete from its industrial roots to an elegant and functional finish for the architectural and design community.

Sadlerstone provides designers with a unique choice in concrete—a choice that offers powerful design possibilities. Our range has expanded from indoor floor tiles to outdoor and now includes contemporary concrete finishes, wall tiles, pavers, countertops, and stair treads to suit any application.

the look / chic / “A natural and earthy warmth that is contemporary, pleasantly tactile and feels good underfoot.” Contemporary concrete finishes & colours, tonal variation, variety of shapes & sizes, depth, warmth, subtle translucence, natural low sheen.

the uses / unique / “The floor is the most important element in the space, creating a dynamic viewing experience, a centerpiece that enables people to be inspired.” Inside to outside, floors, walls and counters allow for simplicity and fluidity in design.

the precision / engineered / “State-of-the-art equipment, consistent quality, guaranteed.” Dimensional accuracy, durable, strong and colour fast, meeting industry standards.

ecoSTONETOPS: DESCRIPTION

The result of 3 years of applied research and development and 30 years of refined concrete experience, ecoSTONETOPS by Sadlerstone Australia are now a reality. ecoSTONETOPS are a beautiful, unique and functional eco-engineered solid surface stonotop developed specifically to give designers an exciting eco-alternative to plastic engineered stone. ecoSTONETOPS are ideal for outdoor kitchens, indoor kitchen countertops, backsplashes, bathroom vanities, fireplace and tub surrounds, furniture, or anywhere you require a unique and durable stone.

Sadlerstone ecoSTONETOPS are an agglomerate of natural materials using cement as the binder that produce surface hardness similar to granite. Unlike other engineered stone, Sadlerstone ecoSTONETOPS have a unique, natural look with characteristics similar to natural stones like granite, marble, travertine and bluestone such as surface scaling, tonal variations, inclusions and formation of pinholes. Concrete is alkaline in nature (like marbles and limestones) and with proper care you can enjoy your ecoSTONETOPS surface for many years never losing interest in its uniqueness.

unique look / natural aesthetic, similar to quarried stones enrich the experience. Simply chic. Traditional Honed and Sawn finishes available.

colour palette / hand selected, naturally occurring inorganic oxides formed into Sadlerstone’s outstanding Signature, Contemporary or ‘avante-garde’ Mode palettes. Granite, marble or bluestone aggregate options.

non-toxic / no resin, cured and treated, inflammable, harmless, recyclable. Simply environmentally preferable.

functional / with hardness properties similar to granite, cutting on the surface will not damage the product. Absolutely suited to indoor and outdoor spaces and will not fade. A full range of complementary Sadlerstone concrete couture products such as in-situ overlays and tile.

cost effective / Australian developed, Australian made, generally price advantaged to other engineered slab material.

Eco-couture

Sadlerstone recognises the need to create a range of products that are not only cutting edge, unique and functional, but also embody the philosophy of our global environmental goals.

process / Sadlerstone aspires to the Quality Assurance principles of ISO 9001 and the Environmental Management principles of ISO 14001 and has attempted to provide a closed-loop manufacturing process wherein we are committed to continual improvement and the prevention of pollution.

material / composed of carefully-selected materials, Sadlerstone is naturally cured at ambient temperatures to provide a durable, low maintenance material.



Lifestyle Concepts: outdoor kitchen unit

Palette

Signature Collection



EBONY BLUESTONE



ALABASTER MARBLE CHIP

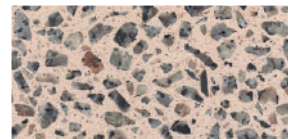

BEIGE



FOSSIL



CONCRETE

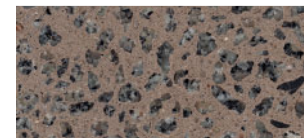

TAUPE

Mode Collection

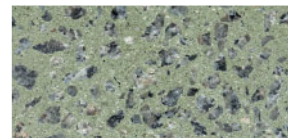

LICHEN

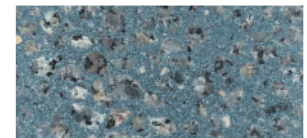

AZURE

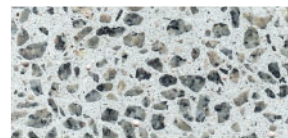

ACIER

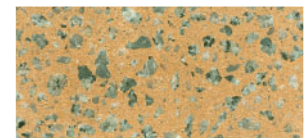

ACACIA

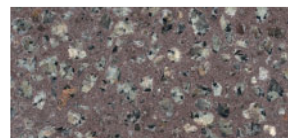

ESPRESSO

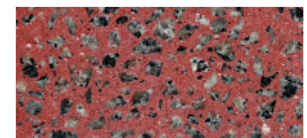

DIABLO

World of Projects

Designers around the world have recognised the one-of-a-kind look Sadlerstone provides. Our impressive list of clients include: Armani, Saks 5th Ave, Hugo Boss, TUMI, Dallas Cowboys, Calvin Klein, Nine West and many more. Sadlerstone features a global supply capability, manufacturer direct, and offers technical support globally.

TECHNICAL SPECIFICATIONS

Specification

| | |
|----------------------|--|
| Slab Tolerances | Size/Rectangularity: $\pm 0.75\text{mm}$ Thickness: $\pm 0.5 - 1.5\text{mm}$ Max Curvature: $\pm 0.5\%$ |
| Installation | Cutting and Installation is to adhere to the Australian Stone advisory Association "guide lines of counter top Installation of September 2010" |
| Recommended adhesive | ecoSTONETOPS To ecoSTONETOPS colour matched Tenax Marble & Stone glue ecoSTONETOPS to Substrate Neutral curing silastic |
| Seal | ecoSTONETOPS is aged, densified & impregnated ex-factory |
| Colour Fastness | Negligible change in colour over 5 years. UV stable. |
| Warranty | 15 Year limited warranty against wear. |

Weight & Sizes

| | | |
|------------------------------------|--------|--------|
| Slabs Sizes are 2460mm x 1240mm | 20mm | 25mm |
| Solid ecoSTONETOPS | 150 Kg | 190 Kg |
| Composite ecoSTONETOPS | 110 Kg | 140 Kg |

Environmental Impact

- Rather than baking or firing, which is often the case with hard-surface countertop alternatives, Sadlerstone is manufactured in efficient sized slabs which are left to naturally cure at ambient temperatures, ensuring an overall lower embodied energy.
- Natural inorganic oxides colour the stone, ensuring the tiles remain colourfast.
- Sadlerstone recycles all manufacturing by-products and operates a closed-loop manufacturing system with zero emissions to air, water or land.
- In addition, as an agglomerate of natural materials, Sadlerstone itself is recyclable and can be used in numerous post consumer applications.

Edge Details

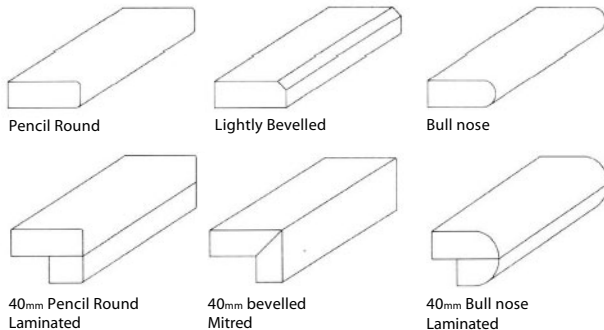

Many more edge details are available, please consult your stonemason for further details.

Material

Polished concrete eco-engineered Sadlerstone surfaces are beautiful, durable and eco-friendly but do require some specific maintenance.





ecoSTONETOPS:

- are ideal for kitchen countertops, bathroom vanities, shower walls tabletops, cladding, sills and fireplace surrounds.
- can be provided to stonemasons for cutting, edging and fabrication in lightweight composite or full body construction in standard slab dimensions of 2460 x 1240mm.
- is an agglomerate of natural materials using cement as the primary binder that produces surface hardness and durability similar to granite.
- are alkaline in nature (like marbles and limestones) and may stain if not cared for correctly. With proper care you can enjoy your surface forever.

INSTALLATION

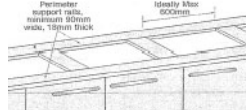
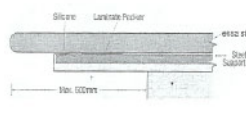
The following is an outline of ecoSTONETOPS installation, finishing and care procedures of a typical installation. Please refer to the Australian Stone Advisory Association's "Countertop Installation Guide lines" available September 2010.

A sturdy level surface is required to support the weight of ecoSTONETOPS. A suitable benchtop support will eliminate the chance of the stone warping or cracking under load during normal applications. A full substrate made from moisture resistant particle board, moisture resistant MDF or moisture resistant plywood is recommended.

| | |
|--|--|
| <p>Substrate</p>  | <p>The perimeter support method requires the use of rails with minimum dimension of 90mm x 18mm positioned at the front and back of the cabinet.</p> <p>Please ensure the weight of the cabinet is adequately transferred to the floor.</p> |
| <p>Spans & Overhangs</p>  | <p>The ideal span between supports is 600mm.</p> <p>Overhangs less than 300mm do not require any additional support.</p> <p>Overhangs between 301mm & 500mm require the support of an 18mm MDF substrate or equivalent.</p> <p>Overhangs of 501mm and over require the fitting of vertical support to the floor such as legs or similar.</p> |
| <p>Exposed Edges</p>  | <p>In an effort to avoid chipping during normal application it is recommended that all exposed edges are finished in a bevel or pencil round edge detail. A bevel of any less than 2mm is not recommended. When laminating edge detail, the laminated strip, should be no smaller than 30mm wide after the re-cut.</p> |
| <p>Installation</p>  | <p>Clean substrate - be sure that there are no hard object on the substrate that may effect the level of the benchtops</p> <p>Pre-arrange - arrange all the countertops in there final place prior to gluing.</p> <p>Check level - using a spirit level, check the level of all countertops paying special attention to joints. If necessary pack beneath the countertop to achieve the desired level and flushness of the joint.</p> <p>Silicon application - in applying the silicon, be sure to spot apply approximately every 200mm.</p> <p>Joints - prior to gluing joints, make sure the countertop has had time to settle into the silicon and re-check levels. The best joint are achieved by loose clamping, so that minimal stress is applied to the ecoSTONETOPS.</p> |
| <p>Finishing</p>  | <p>Finishing - the best finish is achieved by applying TENAX liquid wax. Tenax liquid wax will not only give another level of gloss to the surface but minimise the effects of acid etching.</p> |
| <p>Daily Surface Care</p>  | <p>Maintain with regular cleaning using warm water and a neutral detergent. Periodic sealing and or waxing can increase the level of sheen.</p> <p>Use cutting boards, hot pads and wipe up spills quickly and dry the surface. Longer exposure to spills may result in a stain. Use water and a mild cleaner with a pH between 7 and 10 such as Sadlerstone neutral detergent. Avoid acidic cleaning product.</p> <p>Tips - Cutting on the surface will not damage the product but could blunt your knives! Wipe up spills quickly. Water that pools and evaporates can cause the surface to feel rough. Use hot pads to keep hot pots and pans off the surface. Keep off the surface abrasive cleaners, vinegar, lemon/citrus, wine, coffee. Permanent makers/ink, rust/paint removers, lacquer thinner, oven/metal/tile/drain cleaners and nail polish remover.</p> |